



Amawaterways AmaReina



This 164-passenger vessel boasts spacious stateroom with our exclusive Twin balconies, a choice of dining venues, a heated pool with swim-up bar, in-room interned access and more.

The AmaReina – with her debut in 2014 – is a sister ship to the AmaCerto and features the most advanced design of any river cruise vessel currently in operation. Our exclusive Twin Balconies are available in most staterooms, which measure a spacious 210-235 sq. feet, with four suites measuring 300 sq. feet. Passengers will enjoy gourmet dining with free-flowing fine wines at multiple onboard dining venues; a heated sun deck swimming pool with a 'swim-up' bar; fitness center and spa; complimentary ship-wide Wi-Fi and in-room Internet and Infotainment; and a fleet of bicycles carried onboard for passengers to enjoy on their own or on guided bike tours.

Built in 2014 in the Netherlands
 Length 443 ft., width 38 ft.
 Crew 49 (European)
 Stateroom 79, suites 3
 Registry Switzerland, homeport Basel

Deckplan:

Romantic Danube - 8 days
 Passau - Wenen - Budpest ...



Tell a friend:



Send this URL

 Print this page

 [Download this page in pdf](#)

Categories

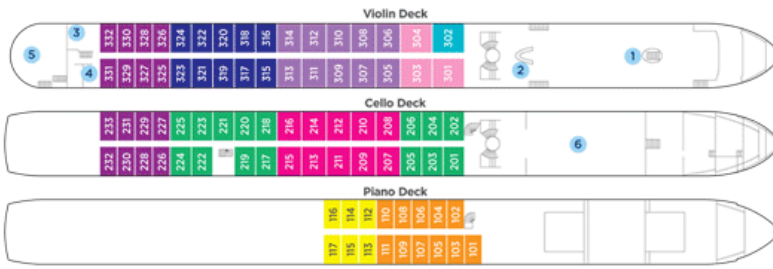

Comfort	
Comfort Plus	
Premium	
Premium Plus	
Deluxe	

For a larger deck plan please visit www.AmaWaterways.com

Suite	Violin Deck French & Outside Balcony - 300 sq. ft.
Cat. AA+	Violin Deck French & Outside Balcony - 290 sq. ft.
Cat. AA	Violin Deck French & Outside Balcony - 235 sq. ft.
Cat. AB	Cello Deck French & Outside Balcony - 235 sq. ft.
Cat. BA	Violin Deck French & Outside Balcony - 210 sq. ft.
Cat. BB	Cello Deck French & Outside Balcony - 210 sq. ft.
Cat. C	Violin & Cello Deck French Balcony - 170 sq. ft.
Cat. D	Piano Deck Fixed Window - 160 sq. ft.
Cat. E	Piano Deck Fixed Window - 160 sq. ft.

Note: Cat. AA+ stateroom has a modified layout

Deck Plan

- 1 Main Lounge
- 2 Reception
- 3 Fitness Room
- 4 Massage & Hair Salon
- 5 The Chef's Table restaurant
- 6 Main Restaurant

Technical Data

Built: AmaVista, AmaSerena - 2015
 AmaSonata, AmaReina - 2014
 AmaPrima - 2013
 AmaCerto - 2012
 Length: 443 ft.
 Width: 38 ft.
 Crew: 49
 Staterooms: 82
 Passengers: 164
 Registry: Switzerland

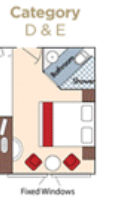
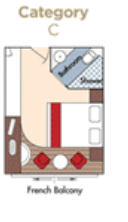
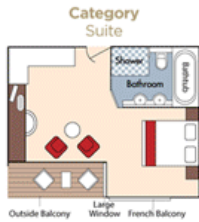

Welcome
 Film
 Contact
 Ships

Danube
 Rhine, Moselle & Main
 Rhône, Saône & Seine
 Elbe
 Wolga & Dnepr
 Douro
 Christmas & New Year Cruises

Promotions
 Seacruises

Brochure
 Contact
 Terms & Conditions (NL + FR)

